

Specification



Brightness Sensor

CATALOG

Functions.....2

Size.....3

Wire definition.....4

Connection.....5

Technical Specifications.....6

Functions

- Simple construction and convenient to install;
- There are visible advantages for future multiple requirements;
- Easy to operate, no need training;
- Compatible with 5 th , 6 th generation controllers and VMF multi-function card;
- Detect the environment brightness in real time, as to adjust the brightness of LED screen automatically;
- Support all kinds of full color led screen;
- Standard with 1.5M cable, but user can extend it to 10M;
- Can be installed in outdoor, the quality is reliable;
- No need connect with power supply alone.

Size

Unit:mm

M12×28

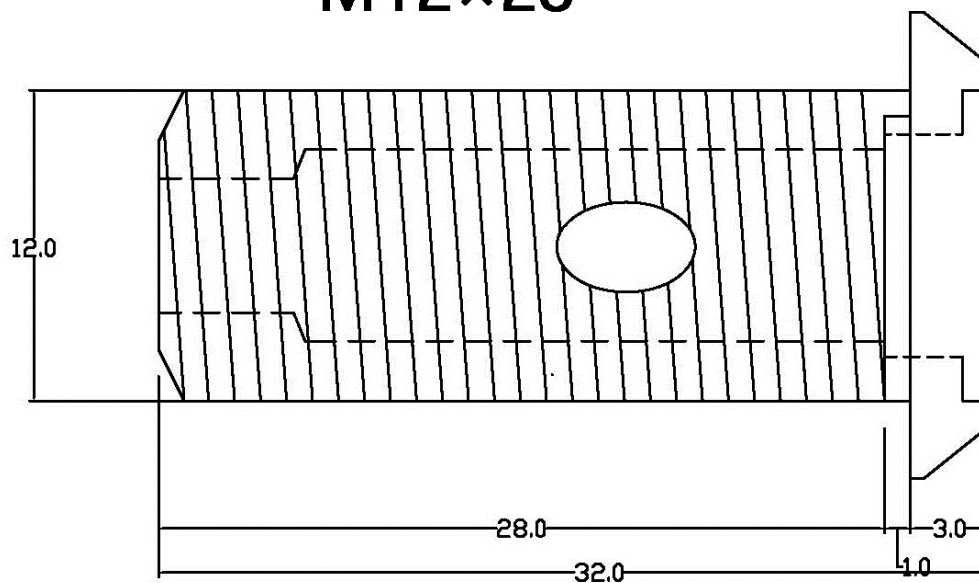

Wire definition

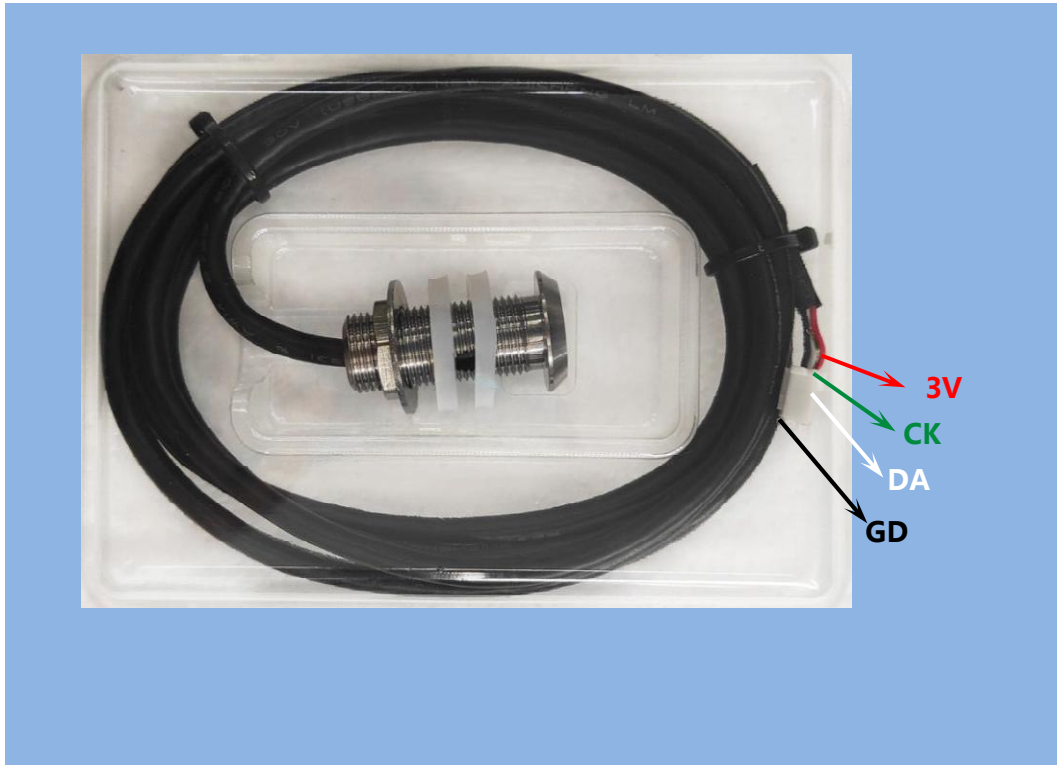

Connection

The sensor can be connected with BX-VMF multi-function card and various controllers which supports brightness sensor functions:

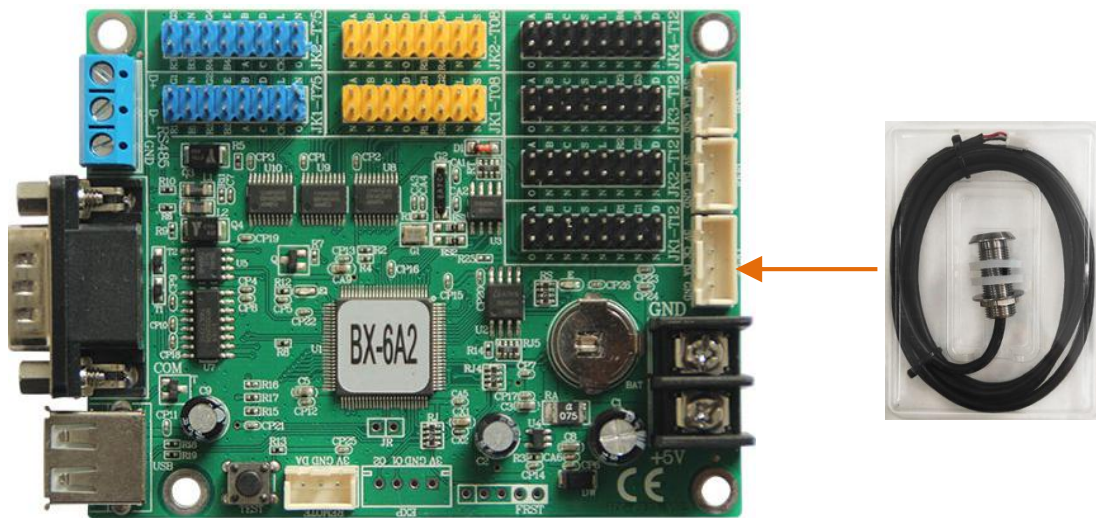
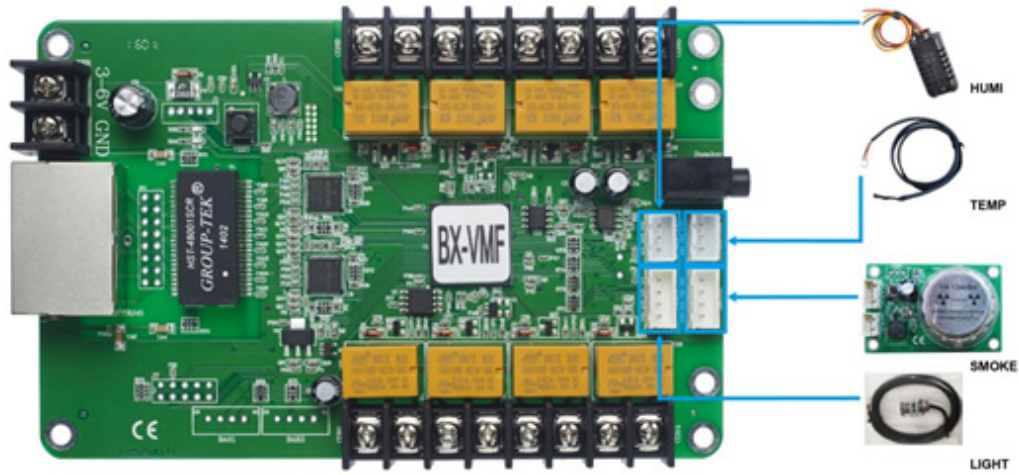

Technical Specifications

1. Measuring range : 1~65535 lux
2. Accuracy : $\pm 20\%$
3. Response speed : 5s (can be customized according to real needs)
4. Working voltage : 3.3V (3.0V~3.6V)
5. Size : M12*29mm
6. Standard length : 1.5m , can be extend to 10m

Contact Us

Shanghai ONBON Technology Co.,ltd (Headquarters)

Address: 7 Floor, Tower 88, 1199#, North Qinzhou Road, Xuhui District, Shanghai City, China

Tel Phone: 086-21-64955136

Fax: 086-21-64955136

Website: www.onbonbx.com

ONBON (Jiangsu) Optoelectronic Industrial Co.,LTD

Address: 1299#, Fuchun Jiang Road, Kunshan City, Jiangsu Province, China

Sales Contacts

Tel: 0086-15921814956 0086-15800379719

Email: onbon@onbonbx.com

Second Development

Tel: 0512-66589212

Email: dev@onbonbx.com

iLEDCloud

Website: <http://www.iledcloud.com/>



Public Wechat



ONBON APP