

# NOISE SENSOR

## Specification



Pls read this user manual before use  
this product.

**BX-ZS (485) noise sensor**

## Statement

Any companies or privates cannot copy, transcribe or translate part or whole content of this file without our written permission. And cannot use it on any business or benefit filed with any forms.

The specifications and information which are mentioned on the file is for reference only, if there' s update, we will not inform you. This file is only for guidance, and all information will not be for any promises.

# CATALOG

GUIDING.....	2
Safety notes.....	2
PRODUCT INSTRUCTION.....	3
Photo.....	3
DESCRIPTION.....	3
Features.....	4
Technical parameters.....	4
DEMENSION.....	5
INSTALLATION DIAGRAM.....	6

# GUIDING

## Safety notes

- ◆ Input voltage is 12V, electric current is 4A, power voltage can't be less than 12V, please make sure the quality of the power supply of sensors.
- ◆ Users are not allowed to disassemble, not to touch the sensor core, so as not to cause damage to the product.
- ◆ As far as possible away from high-power interference equipment, so as not to cause inaccurate measurement, such as frequency converter, motor, etc., installation, disassembly transmitter must turn off the power, The power supply must be disconnected first. Water entering the forbidden transmitter can cause irreversible changes.
- ◆ Please make sure that all the power supply cables are plugged off when you want to connect or plug off any signal or controlling cables.
- ◆ Please make sure that all the power supply cables and signal cables are plugged off when you need to put in or take off the hardware equipment.
- ◆ Please make sure the environment is clean, dry and ventilated when you use this product, also, do not put this product to a high temperature and wet environment.
- ◆ This product is electronic products, please keep away from fire, water source and flammable&combustible products.
- ◆ There's high pressure components in this products, please do not open the box and repair it by yourself.
- ◆ Turn off the power supply immediately when you find smoking, peculiar smell or something unusual. And contact with us soon.

## PRODUCT INSTRUCTION

### Photo



### DESCRIPTION

BX-ZS(485) noise sensor is a high-precision sound measurement instrument, the range of up to 30dB~120dB, to meet the needs of daily measurement, widely used in the home, office, workshop, automobile measurement, industrial measurement and other fields.

## Features

This product adopts capacitance microphone with high sensitivity, stable signal and high precision. It has the characteristics of wide measuring range, good linearity, convenient use, easy installation and long transmission distance.

## Technical parameters

DC power supply (default)	10~30V DC
Power	0.4W
Working temperature of transmitter circuit	-20°C~+60°C, 0%RH~80%RH
Communication interface	485 communication (modbus) protocol baud: 2400、4800 (default)、9600 data length: 8 Parity check system: none Stop bit : 1bit Default ModBus communication address: 1 Function code: 03
Parameters setup	Set the 485 interface by the software
Resolution	0.1dB
Test range	30dB~120dB
Frequency range	20Hz~12.5kHz
Response time	≤3s
Stability	Less than 2% in the lifetime
noise precision	±0.5dB (Reference intonation, 94dB@1kHz)

## DEMENSION





## INSTALLATION DIAGRAM



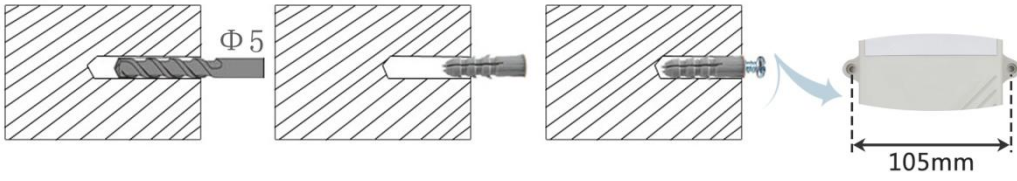

▲ 钻孔

▲ 膨胀塞放入孔内

▲ 自攻螺丝旋进膨胀塞



## CONTACT US

### Shanghai ONBON Technology Co.,ltd (Headquarters)

Address: 7 Floor, Tower 88, 1199#, North Qinzhou Road, Xuhui District, Shanghai City, China

Tel Phone: 086-21-64955136

Fax: 086-21-64955136

Website: [www.onbonbx.com](http://www.onbonbx.com)

### ONBON (Jiangsu) Optoelectronic Industrial Co.,LTD

Address: 1299#, Fuchun Jiang Road, Kunshan City, Jiangsu Province, China

### Sales Contacts

Tel: 0086-15921814956 0086-15800379719

Email: [onbon@onbonbx.com](mailto:onbon@onbonbx.com)

### Second Development

Tel: 0512-66589212

Email: [dev@onbonbx.com](mailto:dev@onbonbx.com)

### iLEDCloud

Website: <http://www.iledcloud.com/>



Public Wechat



ONBON APP